

Athmer Fingerschutz® HS-25 Glas | Door stop HS-25 glass | L'arrêt de porte HS-25 Verre

1/2
HS-25

GLASTÜR - 1 BEDIENELEMENT/GLASS DOOR - 1 OPERATING ELEMENT/PORTE EN VERRE - 1 ÉLÉMENT DE COMMANDE

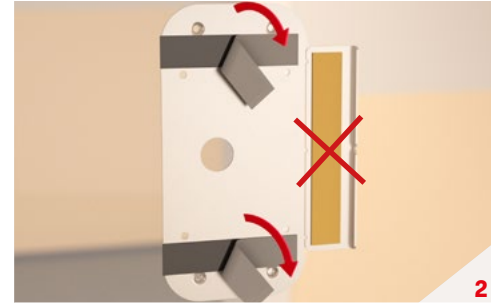
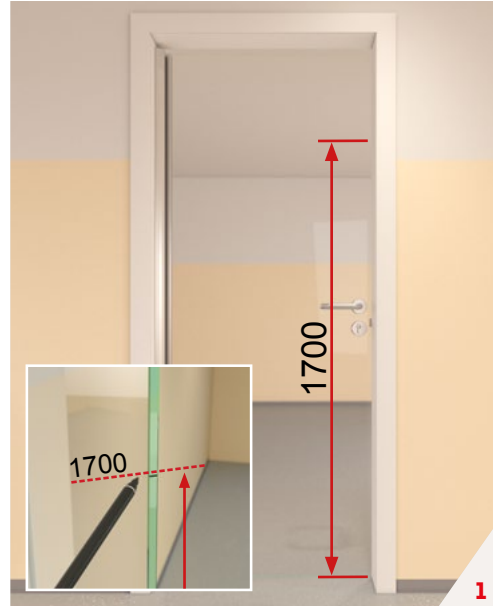

KLEBANLEITUNG

- Die Oberflächen müssen trocken, sowie frei von Staub, Fett, Öl und Trennmittel sein. Beim ersten Andruck korrekt positionieren. Klebeband kann nicht nachjustiert werden!

INSTRUCTION DE COLLAGE

- Les surfaces doivent être sèches et exemptes de poussière, de graisse, d'huile et d'antiadhésifs. Positionner correctement à la première pression. Le ruban adhésif ne peut plus être ajusté !

APPLICATION INSTRUCTIONS

- The surfaces must be dry, free of dust, grease, oil and release agent. Position correctly when pressing on for the first time. Adhesive tape can no longer be readjusted!

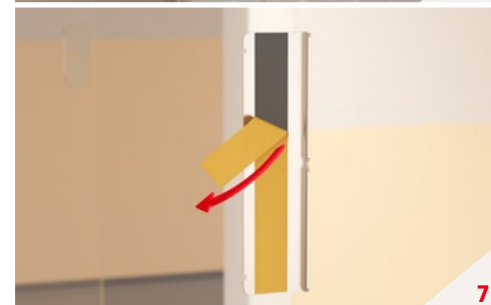
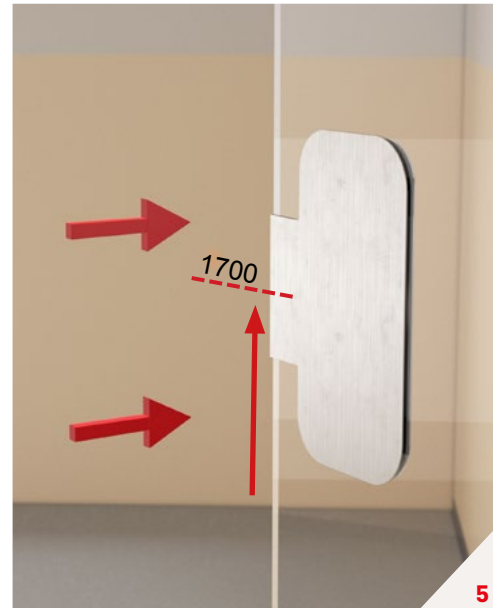
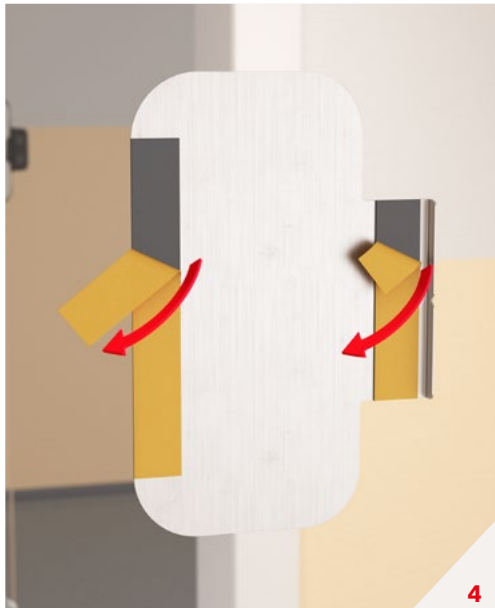
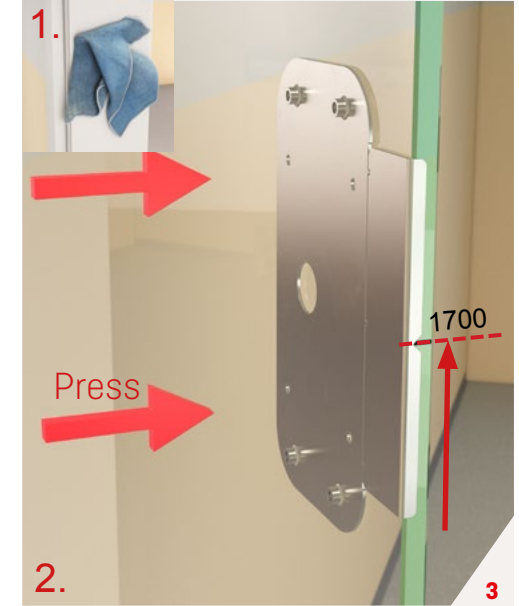

Technische Änderungen vorbehalten
The right to make technical changes is reserved.
Sous réserve de modifications techniques.

athmer oHG / Sophienhammer / 59757 Arnsberg / Germany
T +49 2932 477-500 / info@athmer.de / athmer.com



Produkt Video



Product video



Vidéo produit

athmer

athmer 01.2024/FS4535

Athmer Fingerschutz® HS-25 Glas | Door stop HS-25 glass | L'arrêt de porte HS-25 Verre

GLASTÜR - 1 BEDIENELEMENT/GLASS DOOR - 1 OPERATING ELEMENT/PORTE EN VERRE - 1 ÉLÉMENT DE COMMANDE

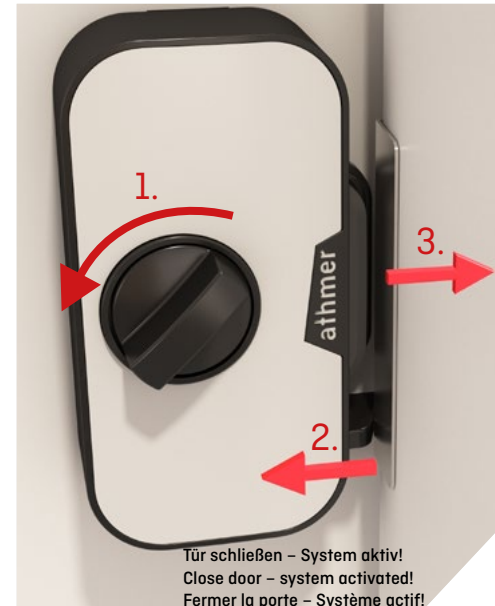
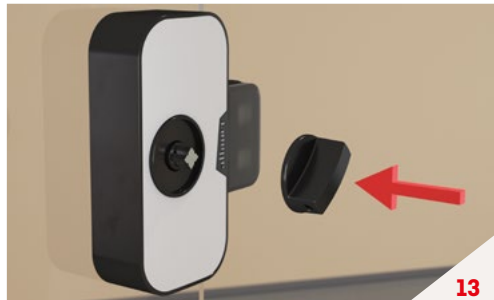
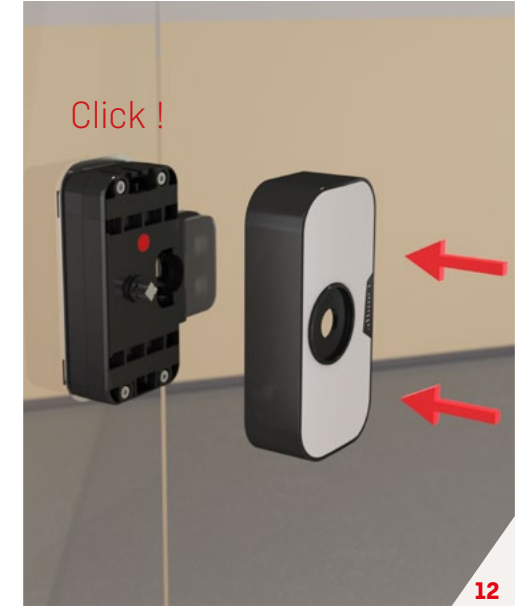
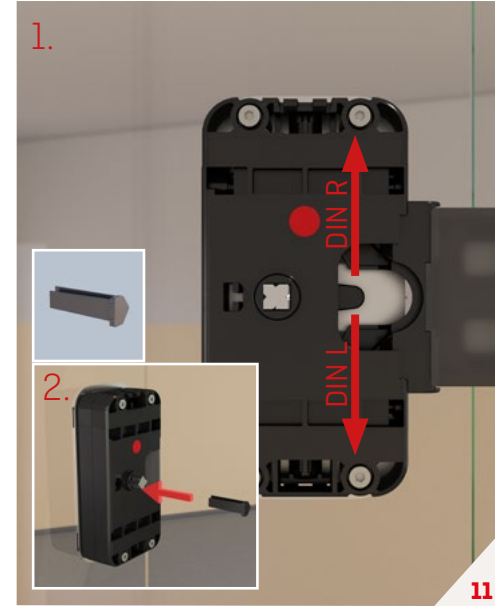
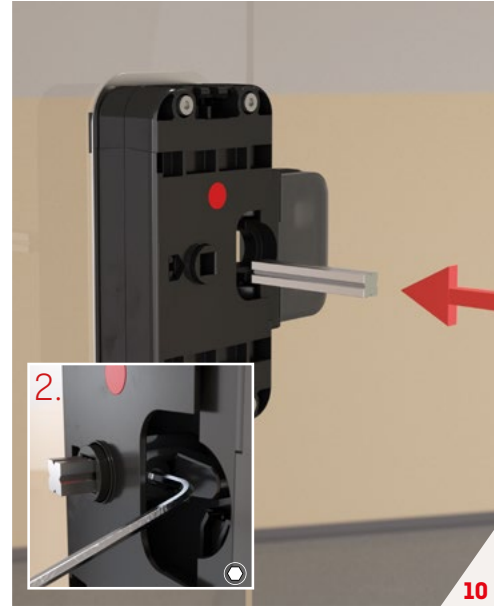
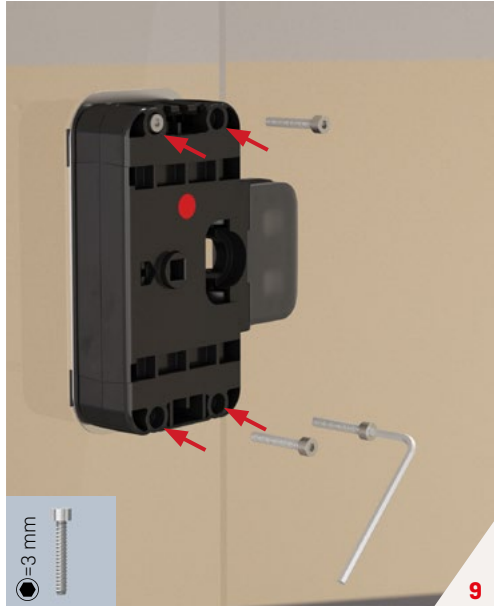

Technische Änderungen vorbehalten
The right to make technical changes is reserved.
Sous réserve de modifications techniques.



Produkt Video



Product video



Vidéo produit

